

GREATER JOHNSTOWN BUSINESS COMMUNITY PROFILE

DIVERSE BUSINESS BASE

Today's Johnstown business community features a multi-faceted economic base that continues to grow and diversify. To complement our traditional manufacturing industries, we've grown solid clusters of companies involved in the defense industry, advanced manufacturing, advanced materials, information technology, environmental technology, and biomedical/biotechnology.

Employment by Industry

Architecture / Engineering	1,420
Arts / Design / Entertainment	780
Building / Grounds Cleaning / Maintenance	3,430
Business / Financial	3,320
Community and Social Service	2,460
Computer / Math	1,010
Construction / Extraction	4,380
Educational / Training / Library	6,220
Farm, Fish, and Forestry	40
Food Preparation	9,590
Healthcare Practitioner	8,350
Healthcare Support	4,230
Installation, Repair and Maintenance	4,380
Legal	300
Life / Physical / Social Science	430
Management	3,550
Office and Administrative Support	17,550
Personal Care and Services	2,060
Production	5,830
Protective Services	2,200
Sales and Related	12,620
Transportation	8,820

Source: U.S. DOL, Bureau of Labor Statistics, May 2005

Comparative Median Hourly Wages by Occupation

	Johnstown	Akron	New York	Los Angeles
Assembler	10.22	13.43	11.64	11.10
Carpenter	15.67	20.42	25.76	23.07
Computer Support	13.34	20.64	24.86	22.25
Computer Systems				
Analysis	27.31	29.42	40.85	36.90
Electricians	21.98	26.51	30.91	23.97
Legal Secretaries	15.86	14.17	21.45	22.83
Machinists	13.97	15.89	18.30	17.58
Management	34.22	44.54	57.55	49.78
Medical Secretaries	11.91	13.50	15.85	14.45
Network				
Administrators	26.18	29.97	37.65	33.10
Office and Administrative Support	11.89	14.19	16.81	15.93
Payroll Clerks	12.55	14.58	17.89	18.21
Plumbers	19.98	19.35	28.46	21.06

Source: U.S. DOL, Bureau of Labor Statistics, May 2006

Cambria/Somerset County Businesses Ranked in Top 100 Businesses in Pennsylvania

Name	Type of Business
1st Summit Bank	Financial institution
The Atrium, a Choice Community	Personal-care facility
Concurrent Technologies Corporation	Applied research and development services
Fiberblade/Gamesa	Wind-energy company
Hiram G. Andrews Center	Rehabilitation facility
JWF Industries	Fabricated metal products
Kuchera Defense Systems	Electronic manufacturing and engineering and design services
L. Robert Kimball	Architecture and engineering services
Major Builders, Inc.	General construction
Memorial Medical Center Conemaugh Health System	Level 1 trauma hospital
Mt. Aloysius College	Four-year college
RNDT, Inc.	Testing laboratory
Saint Francis University Small Business Development Center	Business assistance provider
Windber Research Institute	Medical research institute

Source: PA Business Central (2006)



Johnstown Area Regional Industries
 245 Market Street, Suite 200
 Johnstown, PA 15901
 814.535.8675 • 814.535.8677 fax
www.jari.com



JOHNSTOWN BUSINESS PARK
 Phase II Now Open for Business ...
 Johnstown, PA

LOCATION:

Richland Township, Johnstown, Cambria County, PA.

WATER & SEWER:

Highland Sewer & Water Authority, 10" water line, 12" sewer line.

ELECTRIC:

Penelec, Primary 23 kV service or secondary service of 3-phase 120/208, 120/240 or 277/480V.

NATURAL GAS:

Dominion Peoples, 8" medium pressure line.

TELECOMMUNICATIONS:

Verizon, digital optic fiber network, Atlantic Broadband, HFC CATV network, commercial fiber optic network.

ROADWAY:

Township road.

ZONING:

L-1 Light Industrial. All uses must comply with specific deed restrictions.

JOHNSTOWN BUSINESS PARK

Phase II Now Open for Business ...

Johnstown, PA

OVERVIEW:

The Johnstown Business Park is located in Richland Township, Cambria County, Pennsylvania. The pristine 160 acre site is ideally suited for office, light industrial and warehouse/distribution facilities. All infrastructure and utilities are on-site, including digital fiber optic telecommunications. These light industrial parcels are shovel-ready. The park currently houses over 1,400 employees.

TRANSPORTATION:

The park is located within one mile of US Route 219 with access to the Pennsylvania Turnpike (I-76) and US Route 22. The John Murtha Johnstown Cambria County Airport (JST) is within three miles of the park, offering daily arriving and departing passenger flights. JST also offers general aviation services for public and private aircraft, including paved runways (the longest extending 7,000 feet), fueling, repairs, hangar space, and crash/fire services. JST is centrally located, no more than a 40 to 45 minute drive from anywhere in the region.

WORKFORCE

We have people from all walks of life with a variety of professional backgrounds and the skill sets that are ready for the right employer. We have the people you need to fill the positions in your company.

CIVILIAN LABOR FORCE DATA			
	US	PA	Johnstown
Labor Force	153,784,000	6,324,000	106,000
Employment	145,969,000	6,016,000	99,100
Unemployment	7,851,000	308,000	6,800
Unemployment Rate	5.1%	4.9%	6.4%

Source: PA Center for Workforce Information & Analysis, March 2008

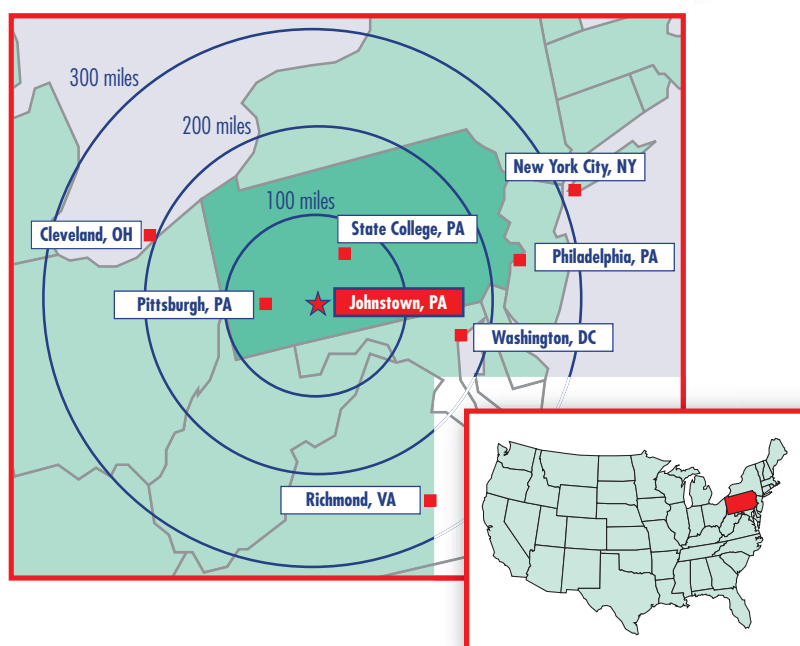

For more information about the Johnstown Business Park, the comprehensive business services that JARI provides or more data from the Johnstown region, please visit us at:

www.jari.com



DISTANCE TO MAJOR MARKETS

	Miles	Miles	Miles
Pittsburgh	70	Cleveland	195
New York	330	Buffalo	240
Philadelphia	240	Detroit	350
Richmond	277	Washington, DC	180

-  Occupied Properties
-  Available for Sale
-  Phase II Area

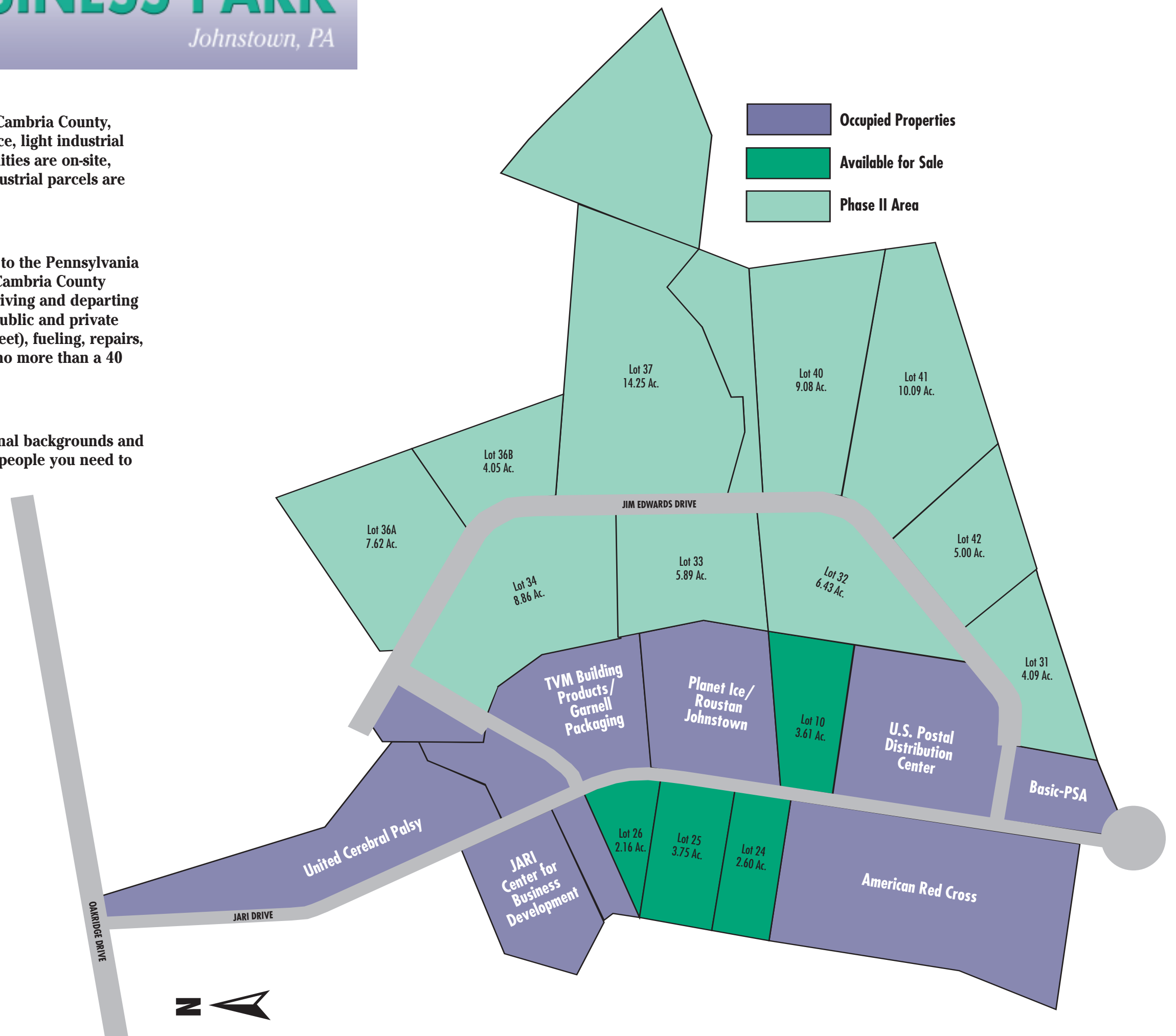

Why do so many national and international companies choose Johnstown, PA?

- Proximity to major markets in the Mid-Atlantic and Northeast. We're within 500 miles of over 50% of the U.S. population (6 out of 10 major U.S. markets) and 60% of Canada's population.
- A cost-effective, capable, and available workforce. Our typical salary costs for the same types of jobs are 18% less than Akron, Ohio, 48% less than New York, NY and 32% less than Los Angeles, CA.
- Numerous educational and training institutions feature specialized workforce training opportunities.
- The security, comfort, and affordability of a "small town" environment coupled with big city amenities. Johnstown has short commute times, reasonably-priced housing, and world-class health care; and is well below the national average in virtually every category for cost of living indices. Employees love living and working here, which keeps morale high, and absenteeism and turnover low.